

## Selecting the correct Rotatruck to suit your milk crate?

There are different sizes of milk crates in Australia. It is important to specify which crates you use to ensure the Rotatruck milk crate Handtruck will work correctly. The Hooks need to engage the milk crates properly at both the top and the bottom (first and third milk crate).

Traditionally, NSW and QLD share the same dimensions and Victoria has a different type, though this is not a hard and fast rule. Use the below images to confirm which milk crate type you have to ensure the Rotatruck will be set up correctly.

Type A milk crate (Traditionally NSW & Other states)

Type B milk crate (Traditionally Vic/Tas)

If your milk crate differs please contact us and provide dimensions, we do cater for other milk crates though they are not as common.



Milk Crate  
11-23MT-STD

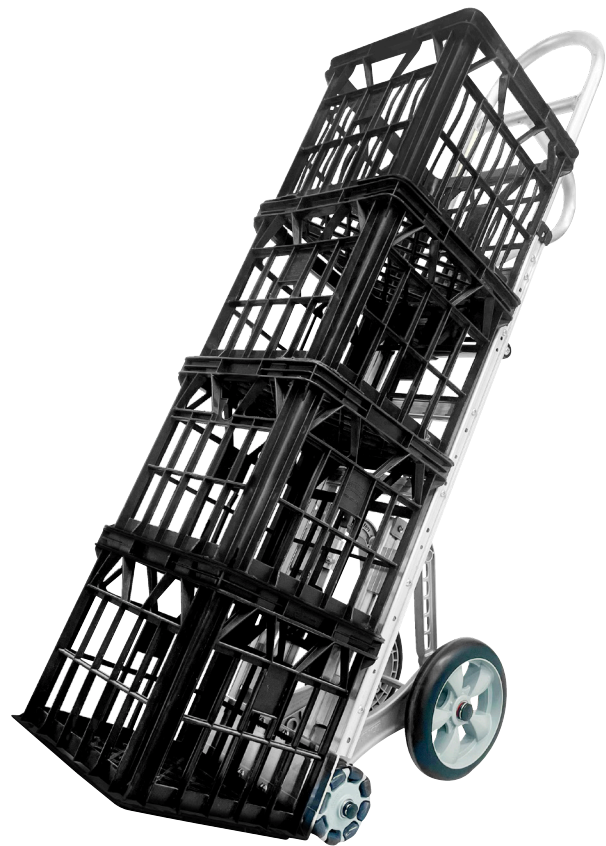

Milk Narrow  
11-23MT-NAR

**TYPE A CRATE**  
(TRADITIONALLY NSW)

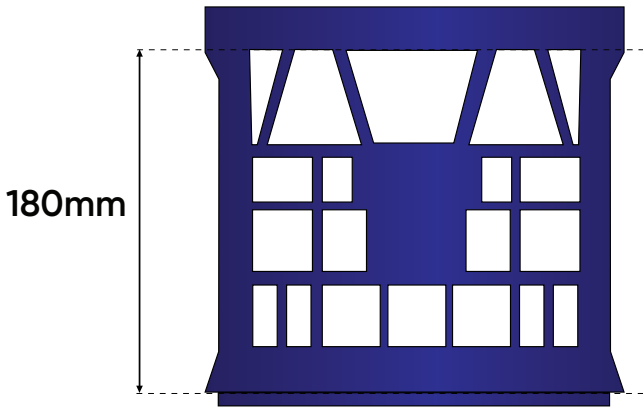

**FRONT VIEW**

**TYPE B CRATE**  
(TRADITIONALLY VIC)

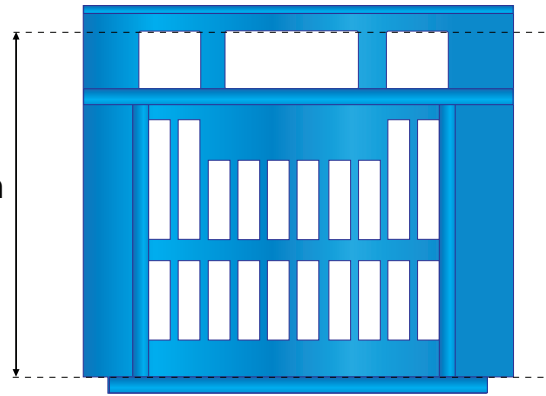

**FRONT VIEW**

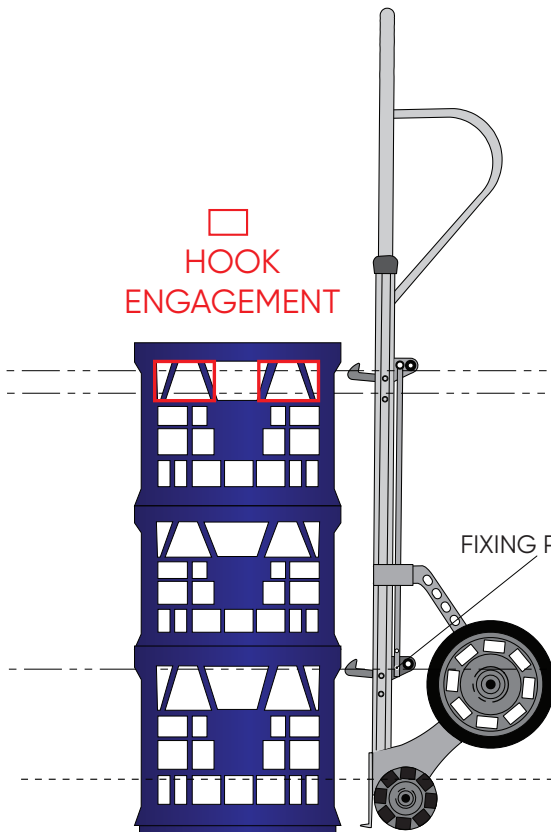

**TYPE A CRATE**  
(TRADITIONALLY NSW)

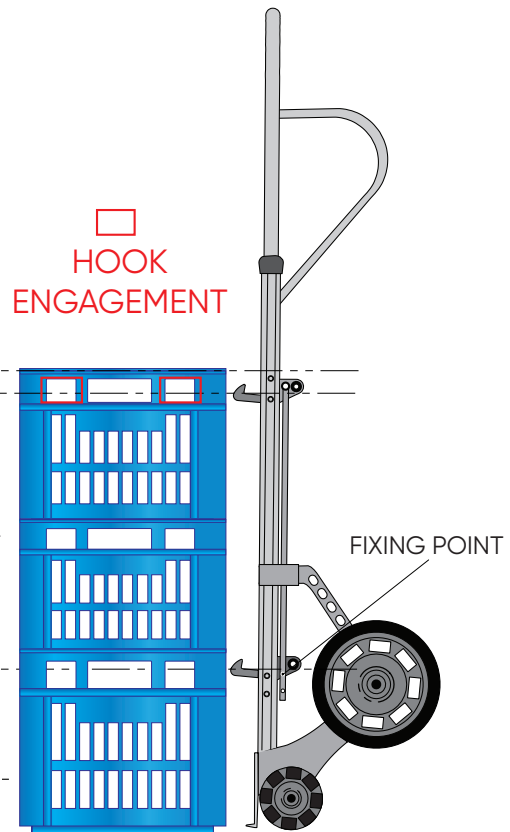

**TYPE B CRATE**  
(TRADITIONALLY VIC)

## TYPE A CRATE (TRADITIONALLY NSW)

### Tools Needed:

- Screwdriver phillips head (PH3)
- Imperial allen key 15/64
- 13mm spanner

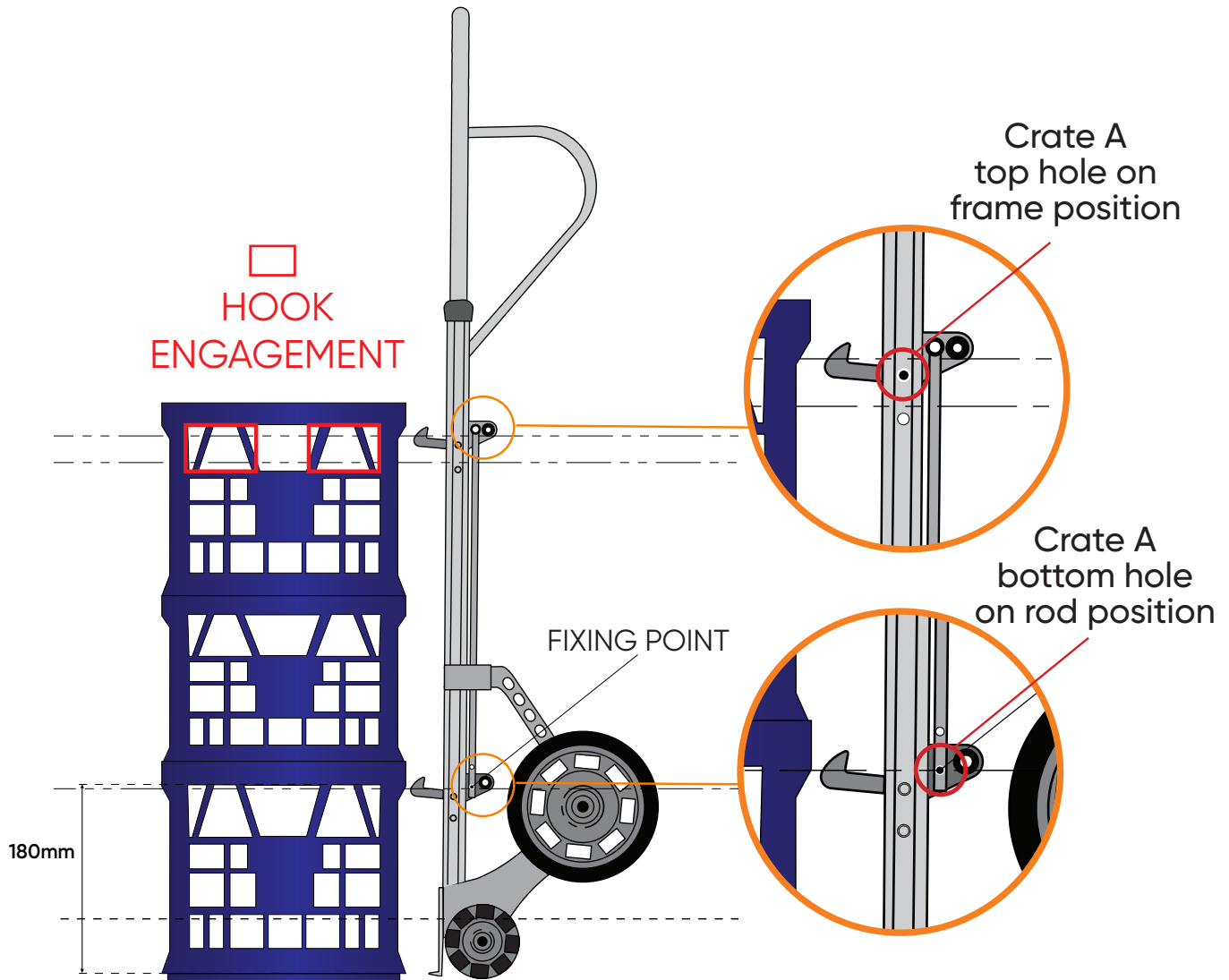

### To convert from a Type A to a Type B Milk crate

1. Release the bottom fixing bolt where the rod is attached into the hook assembly
2. At the top of frame where the hook assembly is attached, release the top of fixing bolt from the frame on both sides then slide the whole hook assembly down to the next hole and reattach the bolts in frame
3. Reattach bolt in top hole of rod at bottom hook
4. Conversion complete

## TYPE B CRATE (TRADITIONALLY VIC)

### Tools Needed:

- Screwdriver phillips head (PH3)
- Imperial allen key 15/64
- 13mm spanner

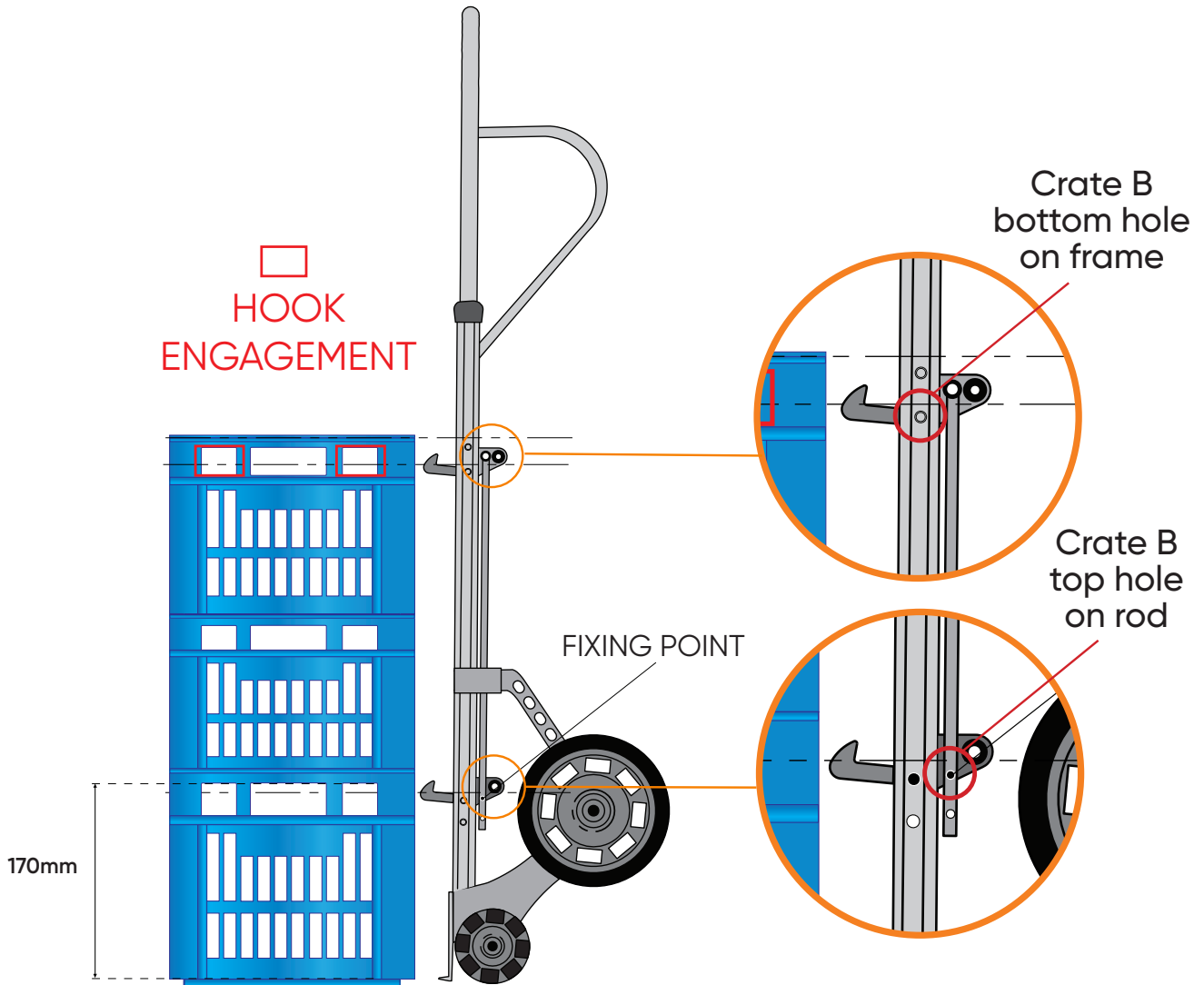

### To convert from a Type B to a Type A Milk crate

1. Release the bottom fixing bolt where the rod is attached into the hook assembly
2. At the top of frame where the hook assembly is attached, release the top fixing bolt from the frame on both sides then slide the whole hook assembly up to the next hole and reattach the bolts in the frame
3. Reattach bolt in bottom hole of rod at bottom hook
4. Conversion complete

## TOP CRATE HOLES ON ROTATRUCK

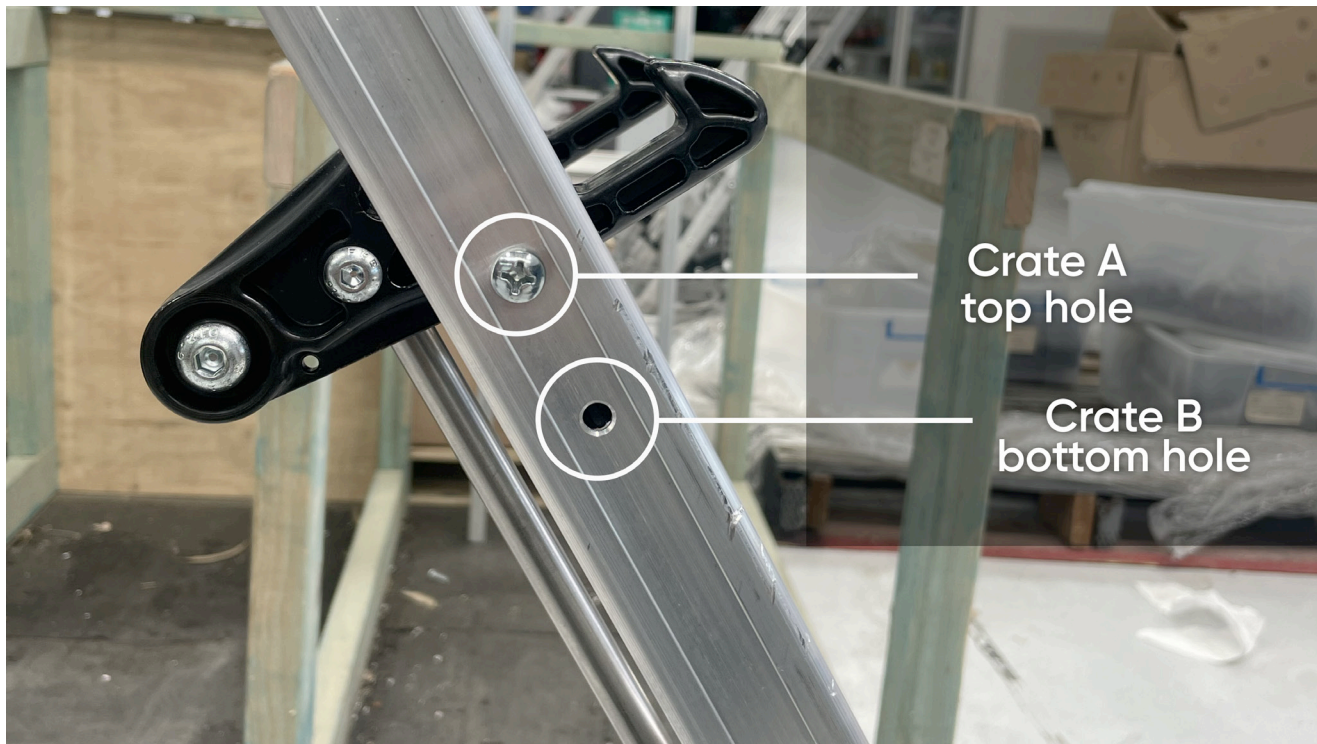

## BOTTOM CRATE HOLES ON ROTATRUCK



PART NUMBERS	
NSW:	VIC:
11-23MT-1070R3-NAR-01	11-23MT-1070R3-NAR-02
11-23MT-1070R3-STD-01	11-23MT-1070R3-STD-02

- STD = wheels are outside the frame NAR = trolleys fit between milk crates



**STANDARD**



**NARROW**